

**NOTICE OF SPECIAL BOARD MEETING  
of the  
TILLAMOOK COUNTY BOARD OF COMMISSIONERS**

Also sitting as the Board of the  
SOLID WASTE SERVICE DISTRICT,  
THE 4-H AND EXTENSION SERVICE DISTRICT  
AND COUNTY ROAD DISTRICT  
to be held

FILED  
437  
JAN 27 2015  
TASSI O'NEIL  
COUNTY CLERK

**Friday, December 12, 2014**

**Special Board Meeting at 10:00 a.m.  
Commissioners' Meeting Room A**  
County Courthouse, 201 Laurel Avenue, Tillamook, Oregon

**BOARD OF COMMISSIONERS**

Bill Baertlein, Chair  
[bbaertle@co.tillamook.or.us](mailto:bbaertle@co.tillamook.or.us)

Tim Josi, Vice Chair  
E-mail: [tjosi@co.tillamook.or.us](mailto:tjosi@co.tillamook.or.us)  
Mark Labhart, Chair

Mark Labhart, Commissioner  
E-mail: [mlabhart@co.tillamook.or.us](mailto:mlabhart@co.tillamook.or.us)

201 Laurel Avenue  
Tillamook, Oregon 97141  
Phone: (503) 842-3403 FAX: (503) 842-1384

ANY QUESTIONS? Contact  
Paul Levesque (503) 842-1809  
E-mail: [plevesqu@co.tillamook.or.us](mailto:plevesqu@co.tillamook.or.us)

COUNTY WEBSITE: <http://www.co.tillamook.or.us>

WATCH THIS MEETING ON TV: TCTV Channel 4

Friday – 1:00 p.m.  
Monday – 7:00 p.m.  
Thursday – 9:30 a.m.

Saturday – 3:30 a.m.  
Tuesday – 10:00 p.m.

Sunday – 7:00 p.m.  
Wednesday – 7:00 a.m.

NOTE: The Board of Commissioners reserves the right to recess to Executive Session as may be required at any time during this meeting, pursuant to ORS 192.660(1).

NOTE: The Tillamook County Courthouse is accessible to persons with disabilities. If special accommodations are needed for persons with hearing, visual or manual impairments who wish to participate in the meeting, please contact (503) 842-3403 at least 24 hours prior to the meeting so that the appropriate communications assistance can be arranged.

**SPECIAL BOARD MEETING – AUDIO12-12-2014.MP3**

CALL TO ORDER: Friday, December 12, 2014 10:00 a.m.

**Vice Chair Josi was absent (Oregon and California Counties – O&C – Annual Meeting)**

1. Welcome & Request to Sign Guest List
2. 0:22 Public Comment – Non-Agenda Items – There were none.
3. 0:25 Consideration of a Project Development Plan from McKinstry Essention LLC for the Tillamook County Courthouse Boiler/Paul Levesque  
A motion was made by Commissioner Labhart and seconded by Chair Baertlein. The motion carried with two aye votes.  
  
42:57 UNSCHEDULED: Oregon State Marine Board Grant Application for Memaloose Boat Ramp Dredging  
A motion was made by Commissioner Labhart and seconded by Chair Baertlein. The motion carried with two aye votes.
4. 50:40 Public Comments – There were none.

**ADJOURN at 10:54 a.m.**

## AGENDA

### SPECIAL BOARD MEETING

CALL TO ORDER: Friday, December 12, 2014 10:00 a.m.

1. Welcome & Request to Sign Guest List
2. Public Comment – Non-Agenda Items
3. Consideration of a Project Development Plan from McKinstry Essention LLC for the Tillamook County Courthouse Boiler/Paul Levesque
4. Public Comments

### ADJOURN

### BOARD MEETINGS AND ANNOUNCEMENTS

The commissioners will hold an executive session on **Wednesday, December 10, 2014** at **3:00 p.m.** pursuant to ORS 192.660(2)(b) to consider the dismissal or disciplining of, or to hear complaints or charges brought against, a public officer, employee, staff member or individual agent who does not request an open hearing. The executive session will be in the commissioners' meeting room A of the Tillamook County Courthouse, 201 Laurel Avenue, Tillamook. The executive session is not open to the public.

A Leadership Team Meeting of the County Board of Commissioners with the Tillamook County Elected Officials and Department Heads will be held on **Monday, December 15, 2014** at **8:00 a.m.** to discuss the county's budget. The meeting will be held in the commissioners' meeting Rooms B in the Tillamook County Courthouse, 201 Laurel Avenue, Tillamook.

The commissioners will hold a workshop on **Monday, December 15, 2014** at **10:00 a.m.** with John Upton for a quarterly report on Tillamook County's Retirement Plan. The workshop will be held in the commissioners' meeting Room B in the Tillamook County Courthouse, 201 Laurel Avenue, Tillamook.

The commissioners will interview applicants for the Tillamook County Futures Council on **Monday, December 15, 2015** at **2:00 p.m.** The interviews will be in the Nestucca Room in the basement of the Tillamook County Courthouse, 201 Laurel Avenue, Tillamook.

The commissioners will hold a workshop on **Wednesday, December 17, 2014** at **3:00 p.m.** with Community Development Department and Information Services for a GIS update. The workshop will be held in the commissioners' meeting Room A in the Tillamook County Courthouse, 201 Laurel Avenue, Tillamook.

The county's holiday schedule and the AFSCME Union Agreement designate **Wednesday, December 24, 2014** as a holiday. Therefore, the Tillamook County administrative offices in the Courthouse, jail, and justice facility, the Road Department, Community Development, Surveyor's office, Tillamook Library and Health Department and clinics and will be **closed** on **Wednesday, December 24, 2014** to allow employees this time off. There will be **no** commissioners meeting on **Wednesday, December 24, 2014**. However, the State Circuit Court will be open on Wednesday.

The Tillamook County Courthouse, administrative offices in the jail and justice facility, Tillamook County Road Department, Tillamook County Community Development Department, Surveyor's office, Tillamook

Library and health department and clinics will be **closed** on **Thursday, December 25, 2014** for the Christmas holiday and on **Thursday, January 1, 2015** for the New Year's holiday.

The commissioners' evening board meeting schedule is as follows:

December 17, 2014	Kiawanda Community Center
January 21, 2015	County Courthouse
February 18, 2015	New Nehalem City Hall
March 18, 2015	Kiawanda Community Center
April 15, 2015	County Courthouse
May 20, 2015	Manzanita City Hall

The evening meetings will begin at 6:30 p.m.



DATUM	ELEVATION
MEAN HIGHER HIGH WATER (MHHW)	5.70'
MEAN HIGH WATER (MHW)	5.00'
MEAN LOW WATER (MLW)	0.80'
MEAN LOWER LOW WATER (MLLW)	0.00'
EXTREME LOW TIDE	-3.00'

ELEVATIONS ARE BASED ON MLLW DATUM

COUNTY TO REMAIN  
 COUNTY OF TILLAMOOK  
 PREVIOUS PERMITS  
 SEDIMENT CONTROL  
 A. SURVEYING & B. B. SOFT PROSPECTION

APPROXIMATE LIMITS  
 UPLAND SEDIMENT  
 DISPOSAL SITE  
 175' x 50' 1/2"

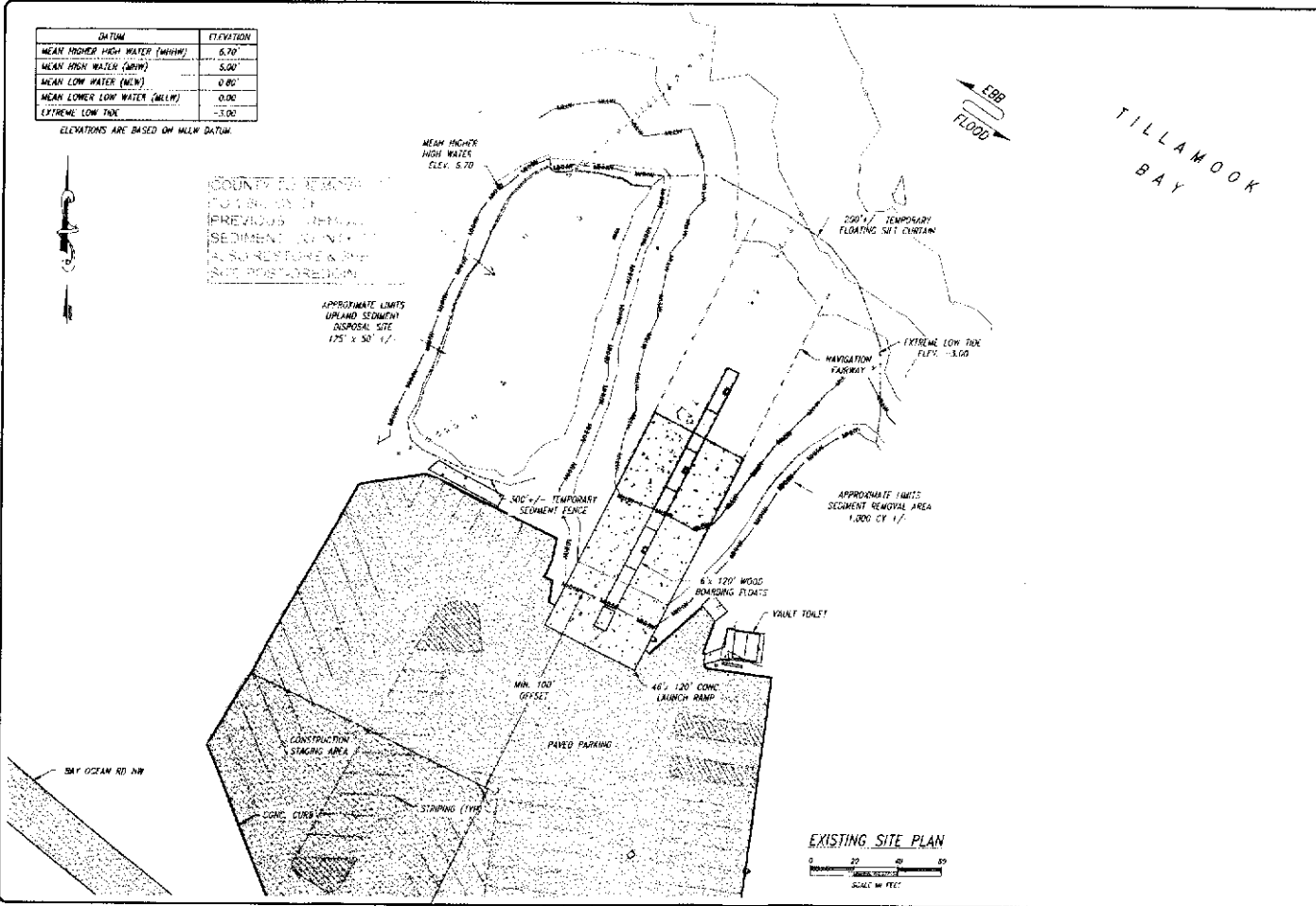

NO.	DATE	REVISION

APPROVED FOR THE BOARD OF COUNTY COMMISSIONERS  
 TILLAMOOK COUNTY, OREGON  
 DATE: 05.28.2014  
 S. JANTZE  
 COUNTY COMMISSIONER



EXISTING SITE PLAN  
 AT WILSONS POINT LAUNCH RAMP TILLAMOOK BAY  
 FOR THE TILLAMOOK COUNTY PARKS DEPARTMENT

OREGON STATE MARINE BOARD

02 05 2014 10:58 AM  
 2014-VG-02



# Boating Facility Grant Application Form

**For Public Boating Facilities**  
**Oregon State Marine Board**

<b>FOR OSMB USE ONLY</b>		Grant Number:
Biennium:	Date Received:	

*Fill in all sections that apply – Leave all other sections blank*

I – APPLICANT INFORMATION		
Applicant or Entity Name: Tillamook County Parks	Telephone Number: 503-322-3477	Fax Number: 503-322-0212
Applicant Mailing Address: PO Box 633	City: Garibaldi	Zip code: 97118
Project Manager Name and Title: Delbert Schleichert, Parks Director		E-Mail: dschleic@co.tillamook.or.us Telephone Number: 503-322-3477 ext 4
Applicant: <input type="checkbox"/> City <input checked="" type="checkbox"/> County <input type="checkbox"/> Port/Park District <input type="checkbox"/> State Agency <input type="checkbox"/> Federal		

Type of Project:		
<input type="checkbox"/> Acquisition	<input checked="" type="checkbox"/> Construction	<input type="checkbox"/> Consultant/Engineering
<input type="checkbox"/> Master Planning	<input type="checkbox"/> Permitting, Environmental/Cultural	
Grant Funds Requested: \$ <u>93,000</u>	Applicant Cash \$ <u>32,000</u>	Other Cash \$ _____
Is this project identified in the Marine Board's 2011-2017 Six Year Facilities Plan? <input type="checkbox"/> Yes <input checked="" type="checkbox"/> No   Priority Ranking: <input type="checkbox"/> Low <input type="checkbox"/> Medium <input type="checkbox"/> High		

II - PROJECT LOCATION		
Facility Name: Memaloose Boat Ramp	Waterbody: Tillamook River	County: Tillamook
Project Name: <i>(What do you want this project to be called?)</i> Memaloose Point Boat Launch Dredging Project		
Location Information: Township <u>1S</u> Range <u>10W</u> Section # <u>22</u> Tax Map # <u>1S 10W 22 DA</u> Tax Lot # <u>100</u>		
River Mile: <u>0</u>	Latitude/Longitude: <u>48.475°N , 123.8889°W</u>	
US Congressional District #: <u>5</u> Oregon Legislative Districts: House: <u>10 &amp; 32</u> Senate: <u>5 &amp; 16</u>		

Property Control and Tenure:  Fee Simple     Lease Agreement     Easement     Condemnation  
 Other (Specify): \_\_\_\_\_ (if yes, explain on separate page)

Number of years remaining in lease \_\_\_\_\_

Name of property owner: Tillamook County

Property Owner Contact Person: Delbert Schleichert

Address: PO Box 633 Garibaldi, OR 97118

Phone: 503-322-3477

Driving Directions – If new location (*Give as much detailed information as possible*)

1 mile West of Tillamook on Hwy 131 Turn Right on Bayocean Road for 1.5 miles

### III – PROJECT DESCRIPTION

**Project Description Narrative:** Describe all elements of the project and the need for assistance, project objectives, and facilities to be constructed, existing facilities which are to be renovated, removed or demolished.

- A.** Describe who will do the work and who will provide supervision. Describe historical site use, community involvement, and the problems or needs that led to the application being submitted.

Contractor to be determined. Supervision will be provided by Tillamook County Parks Department staff.

- B.** Describe how the project relates to current and future public recreation needs, expected results and benefits.

Currently the boat launch provides obstructed, limited access. In the future after dredging 100% of the launch lanes will be accessible for the public and a variety of uses. The immediate future benefits will be to the local community through increased visitor counts /tourism and potential longer stays.

- C.** Describe any actions under consideration that could result in lost opportunity or the facility becoming unavailable for public use. Is there a threat to losing the available local match or the ability of local project sponsor not being able to complete the project with 2 years?

The facility will only be unavailable during the actual short term dredging process. The local match is budgeted and in the Tillamook County Parks Department Capital/Sinking Fund.

- D.** Describe the topography of the site and existing development on the site and how this proposal fits in with development. Also identify the anticipated start and end dates of the project.

Memaloos Point Boat Launch facility is generally flat. It is comprised of an asphalt parking lot, 2 each concrete launch ramps serviced by a centrally positioned boarding docks, 2 stall concrete vault restroom, kiosk and fee station, 2 each night lights.

**Local Need:** Describe to what extent the project satisfies priority needs, as identified in a current planning document (e.g.; park and recreation master plan or city or county comprehensive plan, etc.).



The Memaloose Point Boat Launch satisfies approximately 91% of the current need. The only element required is additional parking as demand has increased over the years.

**Site Suitability:** Describe to what extent the site is suitable for the proposed development project.

The users are very satisfied with the location and because of the sites location, size and ease of access to Rivers and the Bay it is in regular use.

**IV. GENERAL FACILITY INFORMATION**

**Existing Site Features**

- Unimproved
- Ramp. What type of ramp (i.e; gravel, concrete, earth/dirt, pole slide, hoist)? concrete Number of lanes 2
- Transient Tie-Up. What type of decking? \_\_\_\_\_ Broadside or Slips? \_\_\_\_\_ Number of Slips \_\_\_\_\_
- Boarding Floats. What type of material (i.e.; wood, concrete, etc.)? wood Length 132 Feet
- Boat Trailer Parking.  Gravel  Asphalt Number of stalls? 50
- Single Vehicle Parking.  Gravel  Asphalt Number of stalls? 9
- Restroom. What type (i.e.; flush, vault, portable, composting, floating) vault Number of stalls 2
- Pumpout/Dump Station  Fish Cleaning Station
- Marine Fuel Station  Life Jacket Kiosk
- Boat Wash Station  Campground Number of sites \_\_\_\_\_
- Day Use Area

**Estimate the mix of boats that use this facility (based on 100%)**

<16 ft. motorized 24% 17-26 ft. motorized 74% 27 ft. and over 1% All non-motorized 1%

**Types of Boats using this site.**

Personal Watercraft 17% Sail Boats 0%  
 General Pleasure Boat 5% Ski Boats 1%  
 Fishing Boats 75% Cruiser/Yachts 0%  
 Kayak, canoe, other paddle craft 2%

**Estimate the amount of use at this facility**

Launch/Retrievals Per Year: 5000  
 Tie-up/Overnight Moorage Per Year: 0

**List all use fees charged at this site.**

Day Use \$ \_\_\_\_\_ Launch \$ \_\_\_\_\_ Parking \$ 4 Tie-up/Overnight Moorage: \$ \_\_\_\_\_ per ft.

**List any other boating facilities, both public and private (ramps, tie-up facilities or marinas) within a 5-mile radius.**

Name: \_\_\_\_\_ Direction (N,S, E,W): \_\_\_\_\_ Distance: \_\_\_\_\_

1.	Big Barn Marina	SE	2 miles
2.	Burton Frasier	SE	4 miles
3.	Carnahan Park	SE	2 miles
4.	Marine Park	SE	5 miles

**V. PUBLIC INPUT, COMMENT NOTICE AND OPPORTUNITIES**

Describe how you notified neighbors, nearby residents, constituents, etc. of the proposed action. Were there newspaper articles, advisory committees, mailings, posted notices, newsletters, etc.? Attach documents.

Newspaper articles and online news articles

Describe what opportunities you provided for public input or comment. Did you establish a committee, incorporate the proposal into a planning process; hold public hearings; solicit comments through mass media or targeted outreach; place on the agenda of a committee, council, commission or other official public body; or similar means? Attach documents.

Parks Advisory Committee meetings, emails

**Known Public Support/Opposition: (Name)**

	Support	Opposition
Adjacent land owners	_____	_____
Users groups	<u>Tillamook Anglers Society,</u> <u>Tillamook Guide Association. Local Anglers and sport business,</u> <u>Tillamook County Sherrif, Citizens of Idaville, Tillamook,</u> <u>Bay Ocean, Pleasant Valley &amp; Netarts</u>	_____
Neighborhood Assoc.	_____	_____
Local Government	<u>Tillamook County Board of County Commissioners,</u> <u>Tillamook County Park Advisory Committee</u>	_____
State/Federal Government	<u>Oregon Dept of Forestry, Army Corp of Engineers</u>	_____
Legislature/Congressional	_____	_____
Other (Specify)	_____	_____

**VI. MAINTENANCE**

Who will maintain the site when the project is completed?

Applicant  Other (Specify) \_\_\_\_\_

**Estimate annual boating facility operations and maintenance costs \$ 20,578.33**

Describe your plans to operate and maintain the area and/or facility once the project has been completed. How will future maintenance be funded? How much do you expect to budget in dollars and staff hours to maintain area and/or facility?

The Memaloose Boat Launch is one of 21 plus boating facilities maintained by the Tillamook County Parks Department. It will continue to retain its high priority in the system. The Parks Department is self supporting and a special revenue fund designate by the Tillamook Board of County Commissioners. The annual maintenance budget for Memaloose Point Boat Launch is aproximately \$25,000. These funds are used for the following: restroom cleaning, garbage collection, litter pick up & collection, utilities (eg. electricital, vault pumping, parking lot striping, asphalt patching, mowing, weed eating, storm cleanup, launch clean off, dock maintenance, signing and the like)

<b>VII. PROPOSED PROJECT COMPONENTS</b> <i>Note: See Procedure Guide for definitions, Check all that apply</i>					
		Replacement	Expansion	New Construction	Consultant
BOAT ACCESS	Boat Ramp	<input type="checkbox"/>	<input type="checkbox"/>	<input type="checkbox"/>	<input type="checkbox"/>
	Boarding Floats	<input type="checkbox"/>	<input type="checkbox"/>	<input type="checkbox"/>	<input type="checkbox"/>
	Transient Tie-up	<input type="checkbox"/>	<input type="checkbox"/>	<input type="checkbox"/>	<input type="checkbox"/>
	Gangway	<input type="checkbox"/>	<input type="checkbox"/>	<input type="checkbox"/>	<input type="checkbox"/>
	Piles	<input type="checkbox"/>	<input type="checkbox"/>	<input type="checkbox"/>	<input type="checkbox"/>
RESTROOMS	Flush Restroom	<input type="checkbox"/>	<input type="checkbox"/>	<input type="checkbox"/>	<input type="checkbox"/>
	Vault toilet	<input type="checkbox"/>	<input type="checkbox"/>	<input type="checkbox"/>	<input type="checkbox"/>
	Composting toilet	<input type="checkbox"/>	<input type="checkbox"/>	<input type="checkbox"/>	<input type="checkbox"/>
	Utilities	<input type="checkbox"/>	<input type="checkbox"/>	<input type="checkbox"/>	<input type="checkbox"/>
PARKING AREA	Access road	<input type="checkbox"/>	<input type="checkbox"/>	<input type="checkbox"/>	<input type="checkbox"/>
	Paved parking	<input type="checkbox"/>	<input type="checkbox"/>	<input type="checkbox"/>	<input type="checkbox"/>
	Gravel parking	<input type="checkbox"/>	<input type="checkbox"/>	<input type="checkbox"/>	<input type="checkbox"/>
	Curbs, signs, etc.	<input type="checkbox"/>	<input type="checkbox"/>	<input type="checkbox"/>	<input type="checkbox"/>
VESSEL WASTE DISPOSAL (CVA)	Pumpout station	<input type="checkbox"/>	<input type="checkbox"/>	<input type="checkbox"/>	<input type="checkbox"/>
	Dump station	<input type="checkbox"/>	<input type="checkbox"/>	<input type="checkbox"/>	<input type="checkbox"/>
	Floating restroom	<input type="checkbox"/>	<input type="checkbox"/>	<input type="checkbox"/>	<input type="checkbox"/>
	Utilities	<input type="checkbox"/>	<input type="checkbox"/>	<input type="checkbox"/>	<input type="checkbox"/>
MISCELLANEOUS	Dredging	<input checked="" type="checkbox"/>	<input type="checkbox"/>	<input type="checkbox"/>	<input type="checkbox"/>

Breakwater/Bank Protection	<input type="checkbox"/>	<input type="checkbox"/>	<input type="checkbox"/>	<input type="checkbox"/>
Ski Float	<input type="checkbox"/>	<input type="checkbox"/>	<input type="checkbox"/>	<input type="checkbox"/>
Debris Deflection Boom	<input type="checkbox"/>	<input type="checkbox"/>	<input type="checkbox"/>	<input type="checkbox"/>
Informational Kiosks	<input type="checkbox"/>	<input type="checkbox"/>	<input type="checkbox"/>	<input type="checkbox"/>
Land Acquisition	<input type="checkbox"/>	<input type="checkbox"/>	<input type="checkbox"/>	<input type="checkbox"/>
Other (Specify) _____	<input type="checkbox"/>	<input type="checkbox"/>	<input type="checkbox"/>	<input type="checkbox"/>

**VIII. PROPERTY ACQUISITION** *Note: See Procedure Guide for definitions*

Appraisal Completed:  Yes  No Date of Appraisal: \_\_\_\_\_ Type of Appraisal \_\_\_\_\_

Appraised Value of Property \$ \_\_\_\_\_ Assessed Value \$ \_\_\_\_\_

Current Ownership:  Private Owner  Public Agency  Other (Specify) \_\_\_\_\_

Willing Seller  Yes  No Condemnation  Yes  No

Current Zoning: \_\_\_\_\_ Name of Owner (Unless confidential) \_\_\_\_\_

Size Acres: \_\_\_\_\_

Describe what is located on the site and how the site is currently being used:

<b>IX. PROJECT COST – SOFT (NON-ELIGIBLE) FUNDS</b> <i>Not eligible for Facility Grant Funds</i>				
	Applicant	Other**	Board	TOTAL
Administration	\$2500	\$	\$ N/A	\$2500
Pre-Agreement Costs	\$	\$	\$ N/A	\$
Miscellaneous Office Fees (postage, coping, phone etc.)	\$	\$	\$ N/A	\$
Permit Fees	\$500	\$	\$ N/A	\$500
Legal Fees	\$	\$	\$ N/A	\$
System Dev. Charge (SDC)	\$	\$	\$ N/A	\$
Other _____	\$	\$	\$ N/A	\$
<b>Total Soft Funds</b>	<b>\$3000</b>	<b>\$</b>	<b>\$ N/A</b>	<b>\$3000</b>

<b>X. FORCE ACCOUNT COSTS</b> <i>Note: See Procedure Guide for definitions</i>				
	Applicant	Other**	Board	TOTAL
Force Account Labor	\$	\$	\$ N/A	\$
Force Account Materials	\$	\$	\$ N/A	\$
Force Account Equipment	\$	\$	\$ N/A	\$
<b>Total Force Account</b>	<b>\$</b>	<b>\$</b>	<b>\$ N/A</b>	<b>\$</b>

<b>XI. PROJECT COST – HARD (CASH) FUNDS</b>				
	Applicant	Other**	Board	TOTAL
Property Acquisition	\$	\$	\$	\$
Construction Contract	\$32000	\$	\$93000	\$125000
Materials/Equipment	\$	\$	\$	\$
Eligible Permit Fees	\$	\$	\$	\$
Consultant Contract <i>Attach Copy of Contract</i>	\$	\$	\$	\$



An application has  has not  been made for the local approvals checked above.

\*Signature of Local Official: \_\_\_\_\_

Title: \_\_\_\_\_

Date: \_\_\_\_\_

*\*Must be authorized signature from your local City/County Planning Department.*

**XIII. WATERWAY PERMITS** Section 404 of the Clean Water Act, Section 10 of the Rivers & Harbors Act, ect.

	YES	NO	
Are waterway permits required for the project?	<input checked="" type="checkbox"/>	<input type="checkbox"/>	<i>If No, go to Section XIII</i>
Have the waterway permit applications for the project been:			<i>If Yes, provide permit number and date below:</i>
<input checked="" type="checkbox"/> Submitted?	<input checked="" type="checkbox"/>	<input type="checkbox"/>	
<input checked="" type="checkbox"/> Approved?	<input checked="" type="checkbox"/>	<input type="checkbox"/>	

US Army Corps of Engineers Permit. Application/Permit No.: NWP-2000-240 Date 11-24-14

Oregon Department of State Lands Permit. Application/Permit No.: 32692-RP Date 09-08-14

**Other Permit Considerations:**

- Structures in federally navigable waterway may require a Corps' Section 10 Permit.  Applicable  N/A
- Public ramps & floats in state navigable waterways may require a facility license from DSL.  Applicable  N/A
- Projects utilizing foam flotation in floats may require certification with the Marine Board.  Applicable  N/A
- Sites with the Willamette River Greenway may require a Greenway permit.  Applicable  N/A

If permits are required, who will prepare the permit applications?  Applicant Staff  Consultant  Other

*Please identify the Consultant or Other, if known:*

Will the technical assistance of Marine Board staff be requested for permitting?  Yes  No  Unknown

**XIV. ENVIRONMENTAL ASSESSMENT**

**Aquatic Resources**

Will the project require any work to be done below the ordinary high water mark?  YES  NO

If YES, list the ordinary high water elevation: high tide List ordinary low water elevation: low tide

What is the in-water work period authorized by the Department of Fish & Wildlife? Nov 1 through Feb 15

**Describe below the type of in-water work that needs to be done and the size and extent of the area affected:**

The area defined in the permit. See the permits

Are any fish or aquatic species federally listed as threatened or endangered for this waterbody? YES  NO

If YES, identify the listed species: Oregon Coast Coho, Green Sturgeon, Pacific eulachon, Steller sea lions

Is the site on a waterbody that is designated as Essential Salmon Habitat by DSL or ODFW? YES  NO

If YES, describe the extent of the designation: The entire waterway

Describe below how the project may impact the migration, spawning, or habitat of affected salmon species:

Changes to the stream can be harmful to the fish

### ***Terrestrial Resources***

Are any wetlands located on the site? YES  NO

If YES, describe where the proposed work will be in relationship to any wetlands and any impacts:

Have the wetlands been delineated by a qualified expert? YES  NO

If YES, list the name or the individual and affiliation:

Is there any riparian vegetation located on the site? YES  NO

If YES, identify the vegetation and where the proposed work will be in relationship to the vegetation and any impacts:

Are any terrestrial species or habitat federally listed as threatened or endangered on the site? YES  NO

If YES, identify the listed species and where the proposed work will be in relationship to the species and any impacts:

Has the local Oregon Department of Fish & Wildlife or tribal biologist been consulted? YES  NO

Name and phone number of ODFW and/or tribal biologist(s): Rick Klumph, District Manager

### ***Cultural Resources***

Are there any known historical, archaeological, or cultural sites or resources on the site? YES  NO

If YES, describe where the proposed work will be in relationship to these resources and any impacts:

If NO, has the State Historic Preservation Office or tribal officials' been contacted? YES  NO

If YES, identify who has been contacted and the status of any inquiry or review:



## XV. PAST GRANT PERFORMANCE AND COMPLIANCE

Are you in compliance with applicable rules, policies, and guidelines at previously assisted project sites? (No unresolved conversions, maintenance issues, and open to the public)

YES  NO (Grants, Small Grants, MAP)

If NO, please describe:

Please describe your performance on grants previously awarded by OSMB. Were funds expended and project completed by the project deadline? Do you have credit signs at all grant assisted sites? Did you have any amendments made to the grant agreement? Please describe deficiencies if any.

Previously awarded OSMB grant funding for the same project at the same location in 2006.  
Successfully completed project.

**XVI. ATTACHMENTS** *(are the following items attached to this application?)*

- Cover Letter
- Existing Condition and Use Photographs
- Location/Vicinity Map (Assessor's map)
- Design/Engineering Plans
- Letter (s) of Support or Opposition (emails accepted)
- Complete Copy of Permits
- SHPO Clearance and/or Cultural Resources Report
- Force Account Materials & Supply Record
- Force Account Equipment Record
- Force Account Labor Timesheet Estimate
- Acquisition Checklist & Supporting Documents (if applicable)
- Consultant Contract (if applicable)

**Applicant signature**

Application is hereby made for the activities described herein. I certify that I am familiar with the information contained in the application, and, to the best of my knowledge and belief, this information is true, complete, and accurate. I further certify that I possess the authority including the necessary requisite property interests to undertake the proposed activities.

I also certify that the Applicant's governing body is aware of and has authorized the person identified as the official representative of the Applicant to act in connection with this application and subsequent project as well as to provide additional information as may be required.

By signature below the Applicant intends to enter into a Cooperative Facility Grant Agreement and agrees to comply with all applicable federal, state and local laws and Oregon State Marine Board's program rules, policies and guidelines in conjunction with this proposal and resulting project if so approved.

Delbert F. Schleichert  
Print/Type Name

Parks Director  
Title

\_\_\_\_\_  
Applicant Signature

\_\_\_\_\_  
Date

Note: Instruction regarding this application and the facility grant program can be found in the Facilities Program Procedure Guide, or you may contact the Boating Facilities Section Manager, Oregon State Marine Board, 435 Commercial St. N.E. #400, PO Box 14145, Salem, Oregon 97309, Ph: (503) 378-2605